

송광초등학교(부1.창고1)

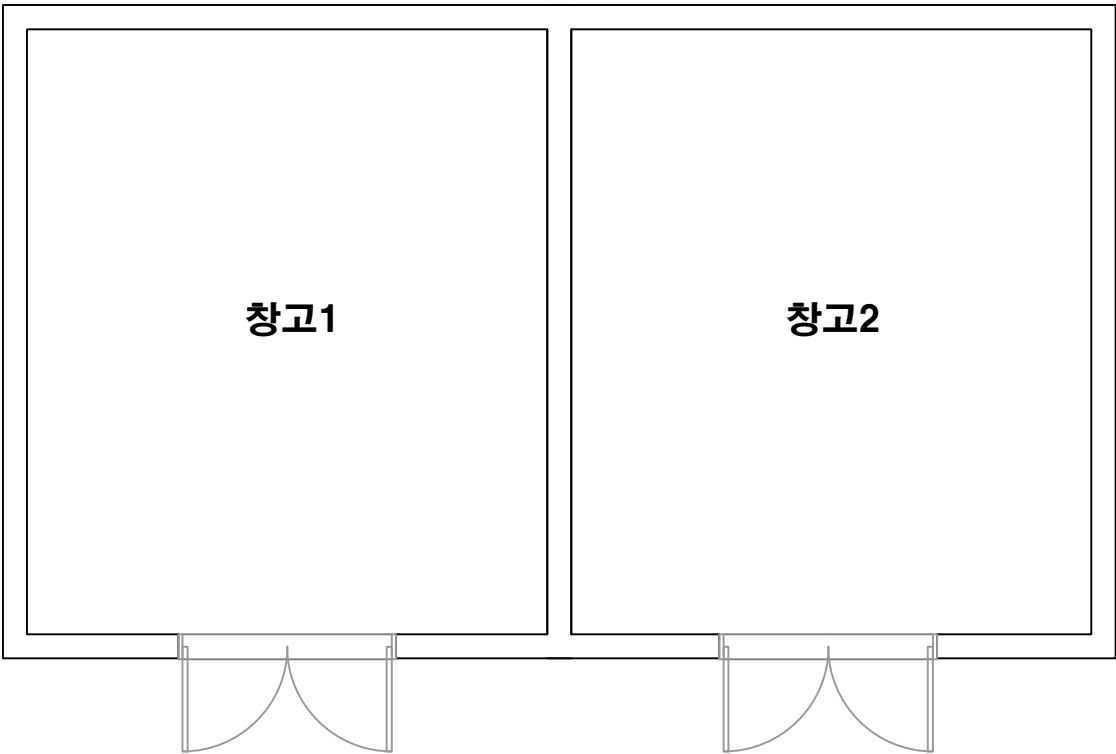

건축자재별 그림 범례

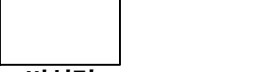
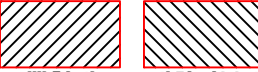
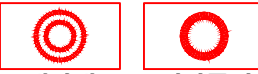
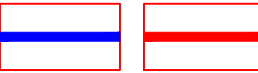
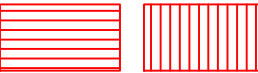

*건축자재 인식표



석면 함유 시료



석면 비함유 시료

*건축물명 : 송광초등학교 (부1.창고1)

*건축물소재지 : 전북 완주군 소양면 송광새터길 16-3

*도면번호 : 14-10-11-01

*석면조사기관 : (주)알파석면연구소

*석면분석기관 : (주)알파석면연구소

*조사일자 : 2014.10.11.

송광초등학교(부1.창고2)

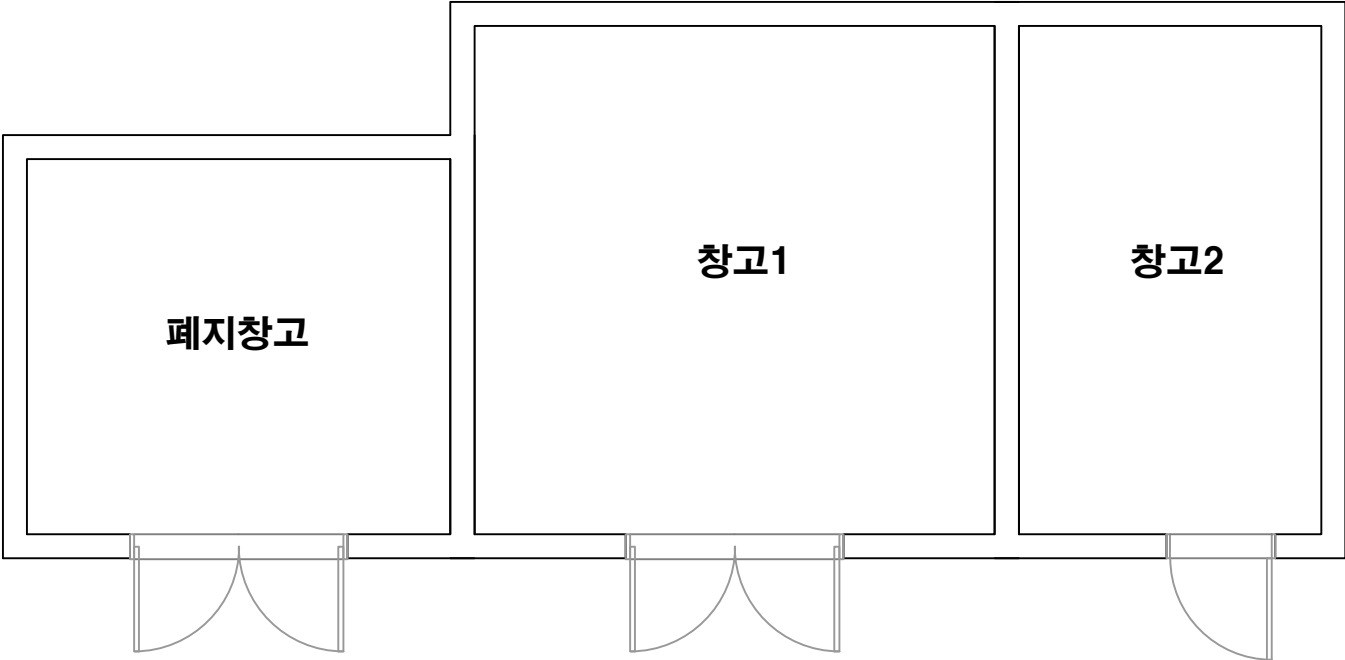

건축자재별 그림 범례

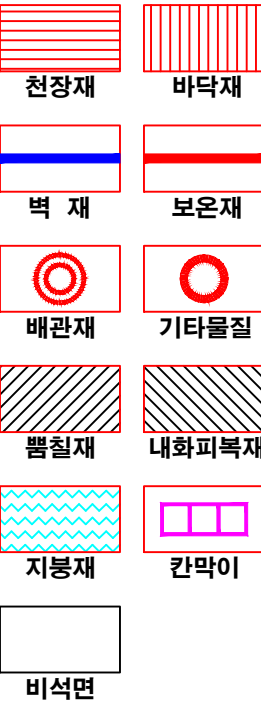

*건축자재 인식표

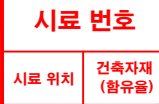

석면 함유 시료



석면 비함유 시료

*건축물명 : 송광초등학교 (부1.창고2)
*건축물소재지 : 전북 완주군 소양면 송광새터길 16-3
*도면번호 : 14-10-11-02
*석면조사기관 : (주)알파석면연구소
*석면분석기관 : (주)알파석면연구소
*조사일자 : 2014.10.11.