

# CABLE SCHEDULE SIZE

NO	C A B L E	CONDUIT	비 고
1	FCV 25sq-4C, E FGV 10sq	기존 배관	
2	FCV 16sq-4C, E FGV 6sq	기존 배관	
3	FCV 4sq-4C, E FGV 4sq	CD 28C	노출배관

전력간선 개통도

▼ 옥상 ▼

▼ 지상3층 ▼

▼ 지상2층 ▼

▼ 지상1층 ▼

MCC

③

L-3-1

L-3-2

②

L-1-1

L-1-2

①

WHM

WHM

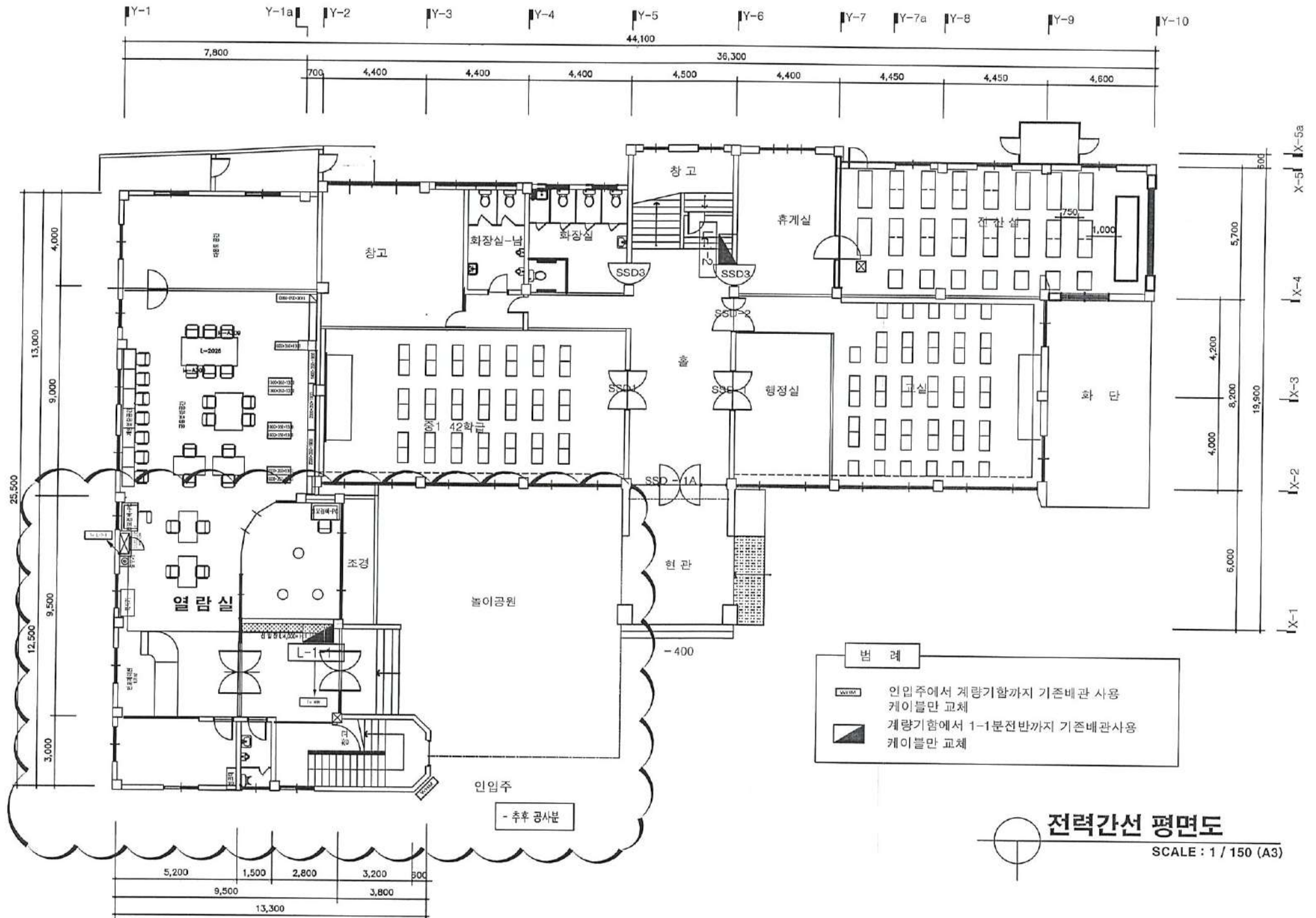

# 본전반 결선도

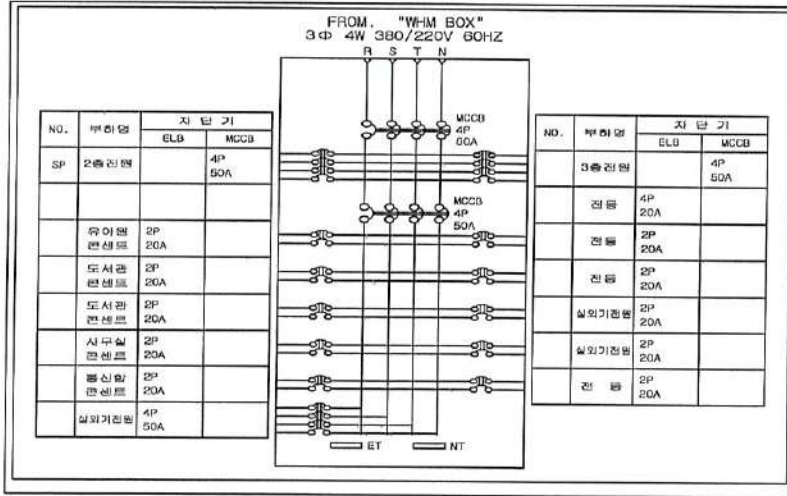

PANEL BOARD " L-1-1 "(변경전)

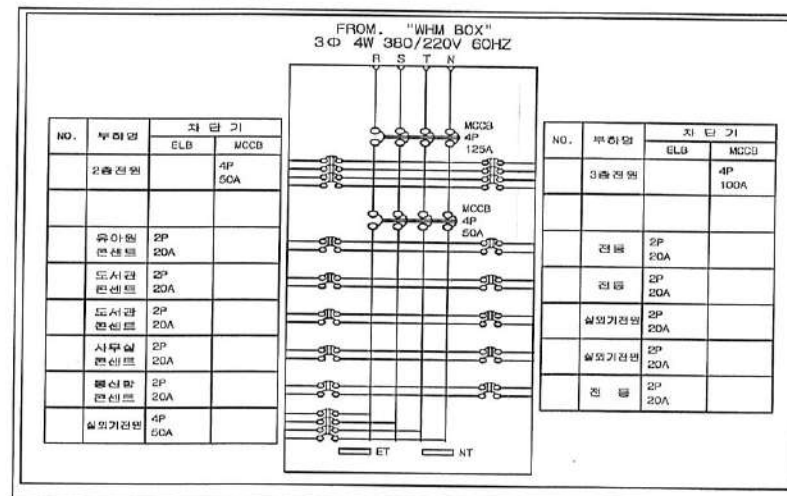

PANEL BOARD " L-1-1 "(변경후)

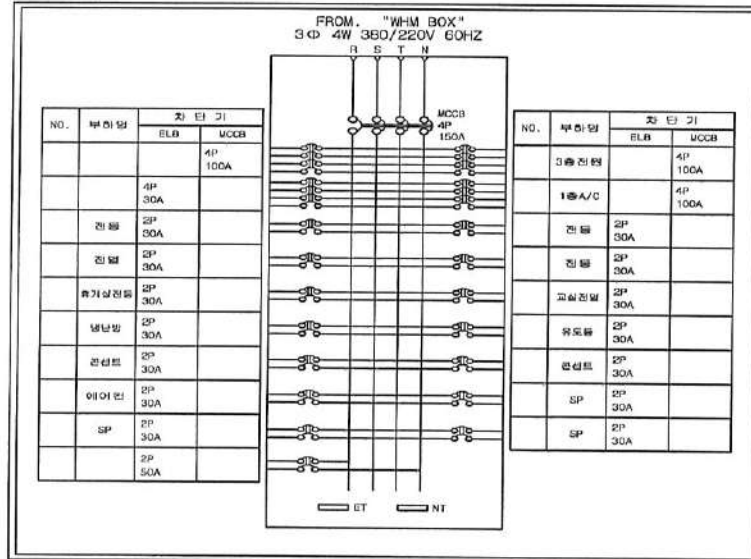

PANEL BOARD " L-1-2 "(변경전)

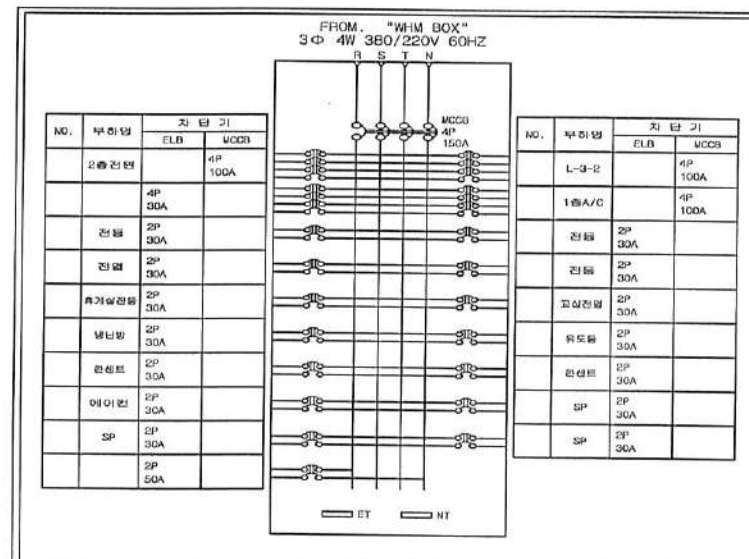

PANEL BOARD " L-1-2 "(변경후)

1층 본전반 결선도

# 분전반 결선도

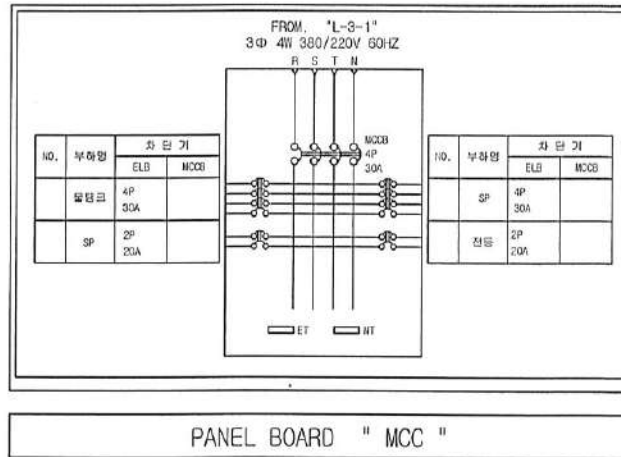
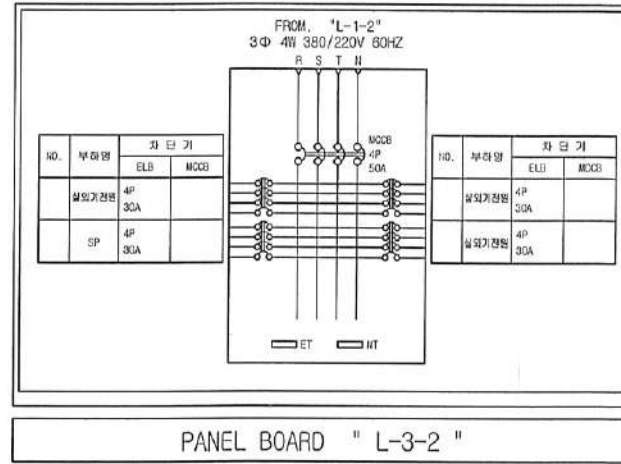
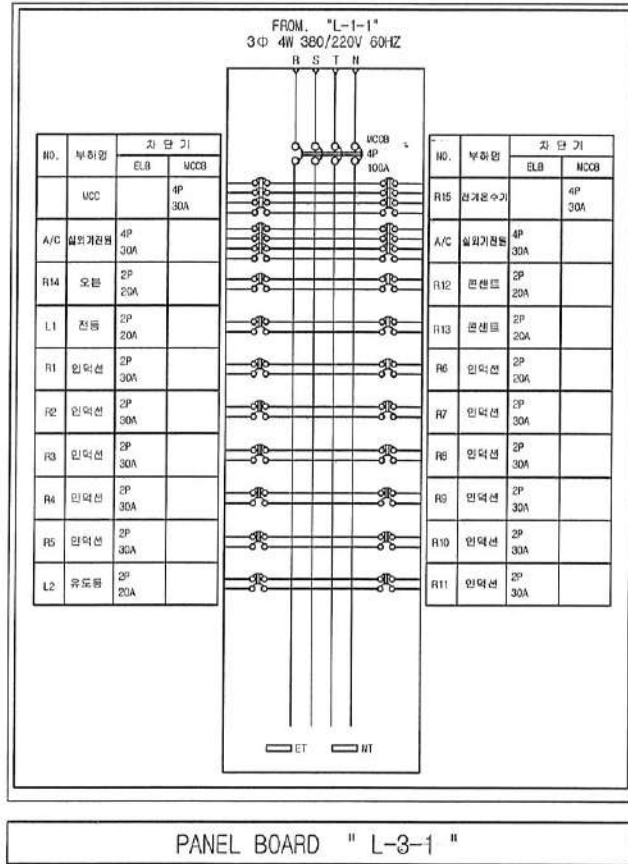



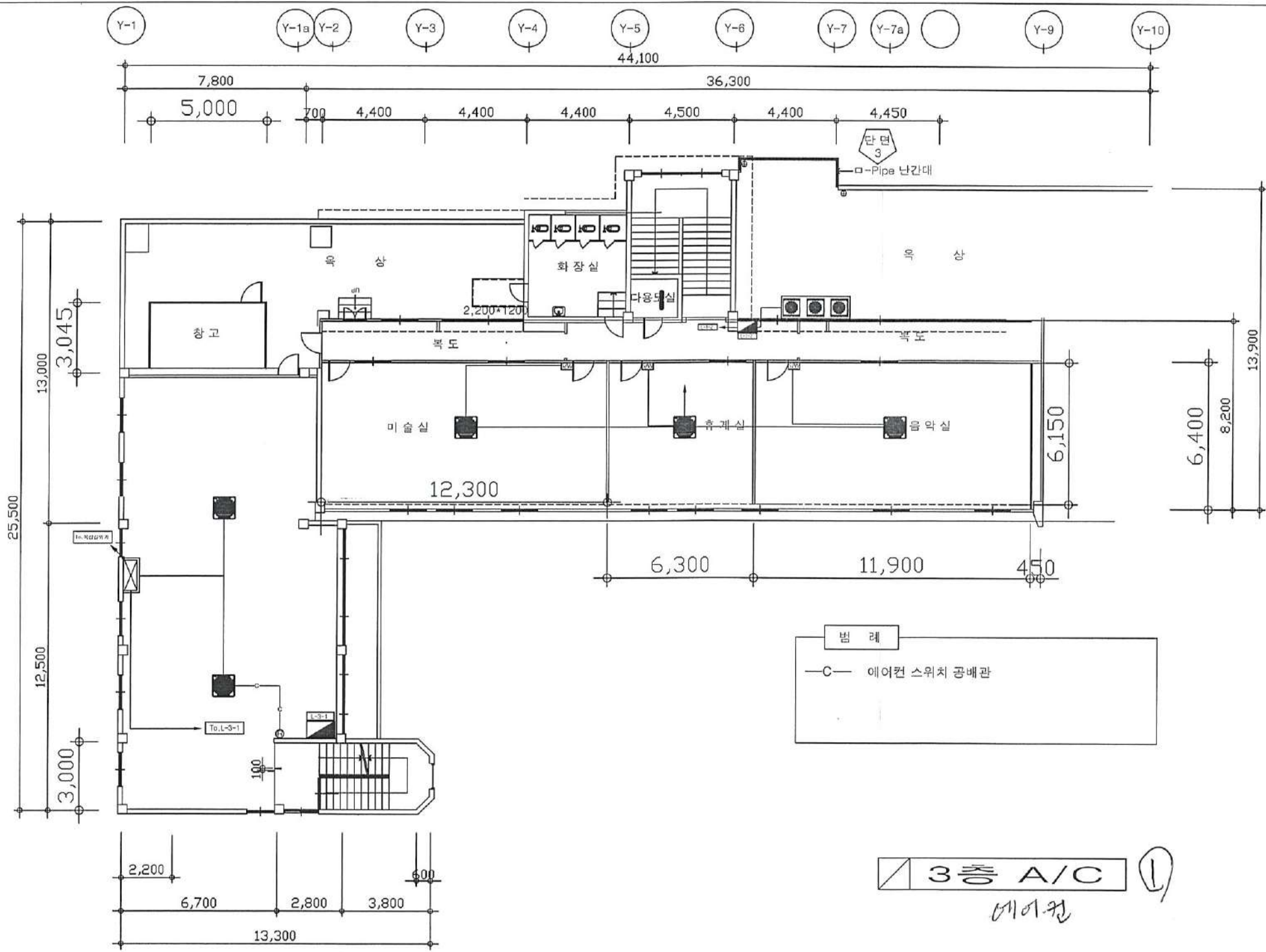

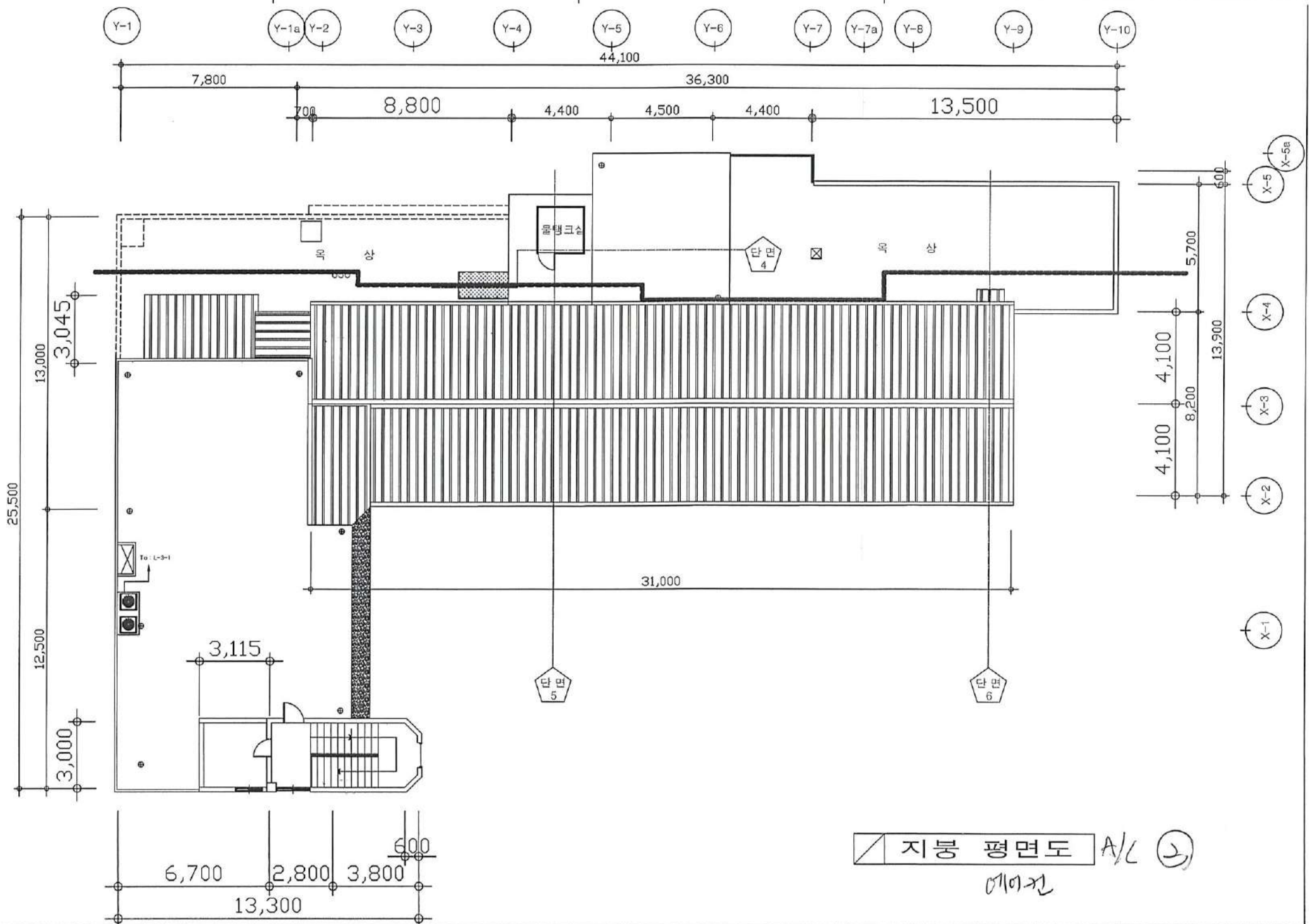

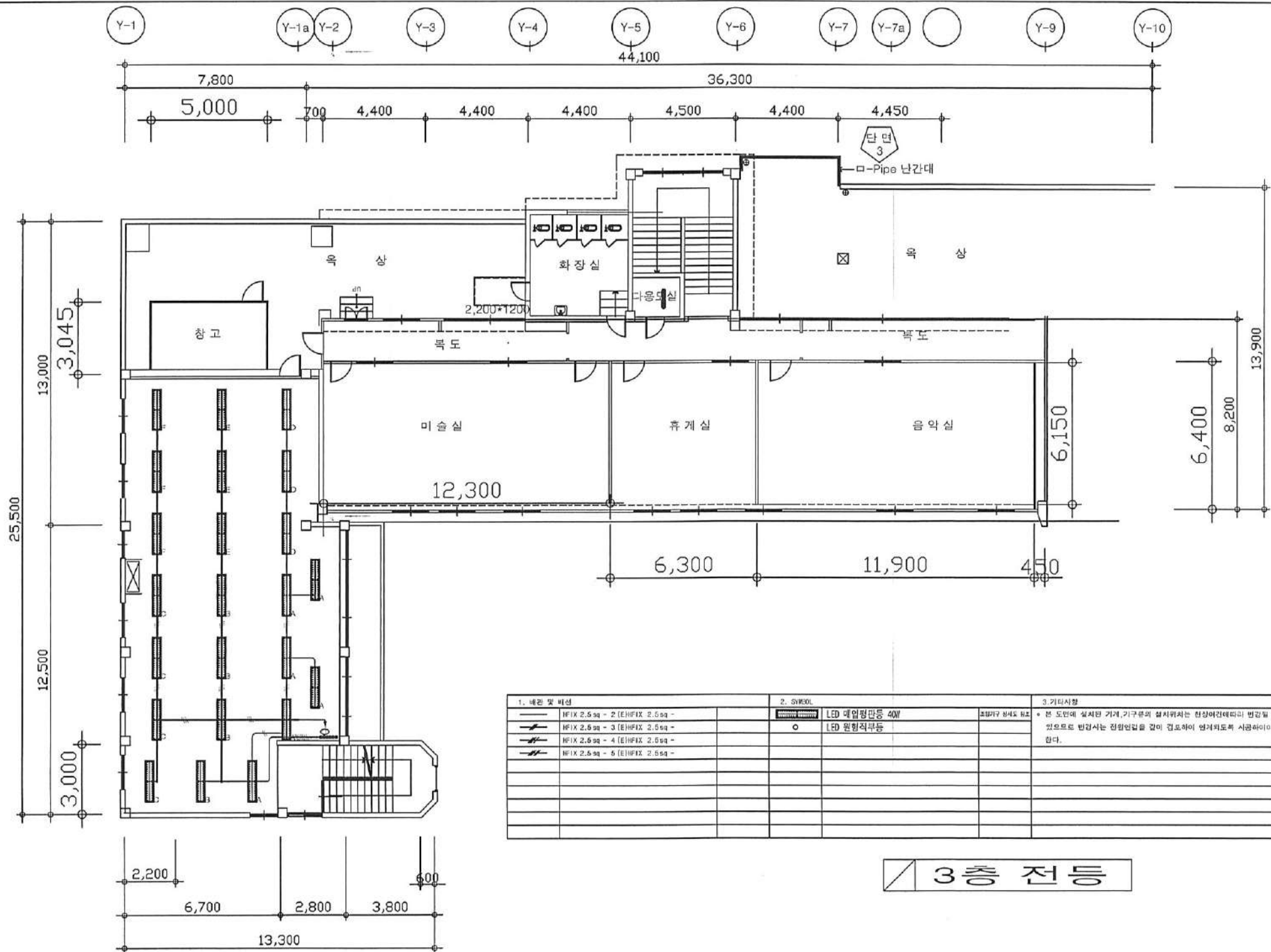

1. 내관 및 배선	2. SYMBOL	3. 기타사항
— HFIX 2.5sq - 2 (EH)FIX 2.5sq -	LED 매입형광등 40W	본 도면에 실려진 기계,기구류의 설치위치는 한상여건에따라 변경될 수 있으므로 변경시는 전담인원을 같이 검토하여 변경피도록 시공하여야 합니다.
— HFIX 2.5sq - 3 (EH)FIX 2.5sq -	LED 원형직광등	
— HFIX 2.5sq - 4 (EH)FIX 2.5sq -		
— HFIX 2.5sq - 5 (EH)FIX 2.5sq -		

3층 전등

1. 배관 및 배선			2. SYMBOL			3.기타사항
——	HFIX 2.5 sq - 2 (E)HFIX 2.5 sq -			LED 매입평판등 40W	조명기구 상세도 참조	○ 본 도면에 설치된 기계,기구류의 설치위치는 현장여건에따라 변경될 수 있으므로 변경시는 전원연결을 같이 검토하여 연계되도록 시공하여야 한다.
—#—	HFIX 2.5 sq - 3 (E)HFIX 2.5 sq -		○	LED 원형직부등		
—##—	HFIX 2.5 sq - 4 (E)HFIX 2.5 sq -					
—###—	HFIX 2.5 sq - 5 (E)HFIX 2.5 sq -					

3층 전등



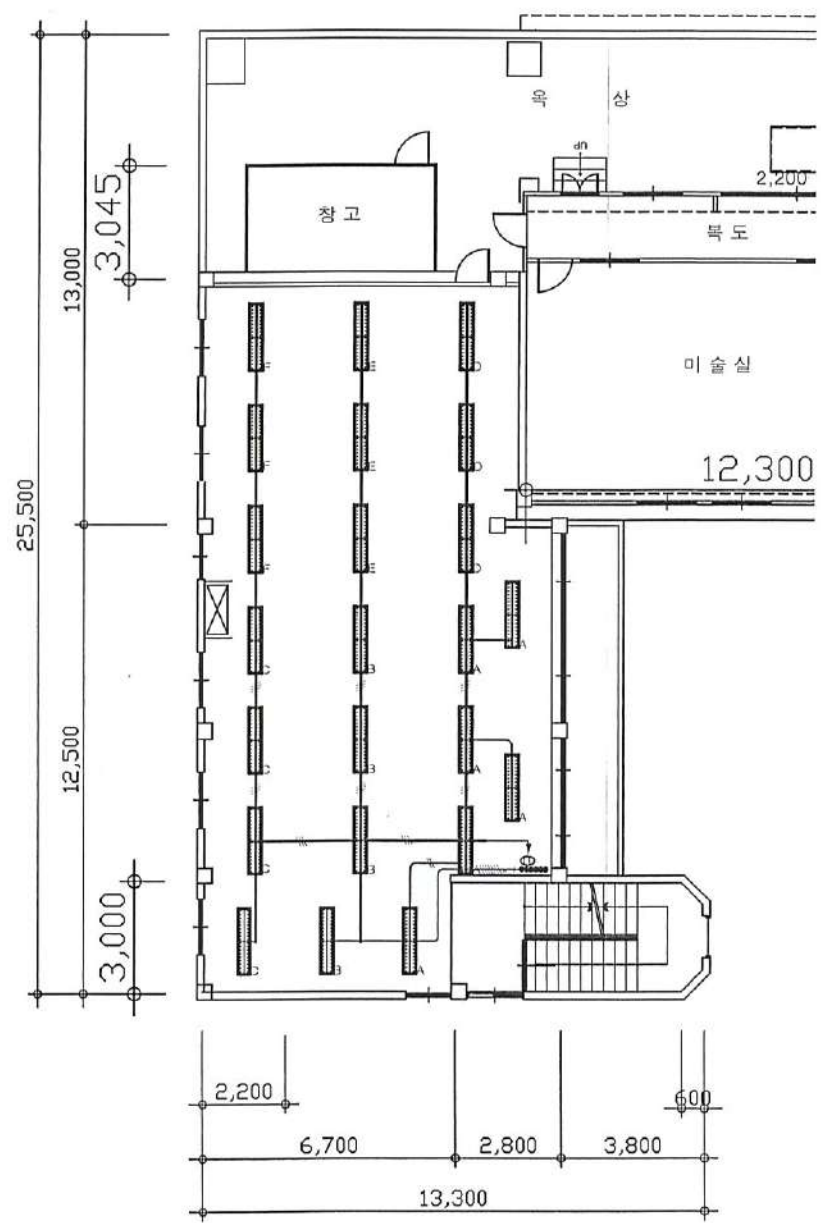

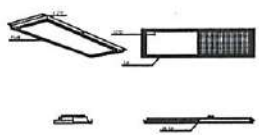

# 조명기구 상세도

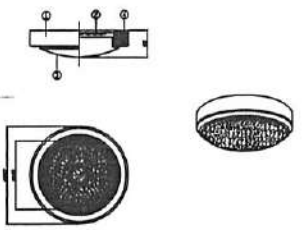

형 태	LED면광형 / 매너지절역형
인증사항	KS, 고효율, 친환경, 공효율 110lm/w이상
프레임	ALUMINUM
커 비	광확산PC
컨버터	LED40W
열 프	LED40W
몸 체	STEEL 0.7T
특이사항	플러커지갑, 전자기파차감 재료 사용



형 태	LED 원형 직부등
L A M P	LED 16W 이상
커 비	ADJUST
CONVERTER	전자식 LED SMPS
B O D Y	STEEL
기 타	고효율, 환경인증, KS
특이사항	



TYPE " A "

TYPE " C "

- 조명기구 선정은 발주처와 상의후 결정할것

